

GASOLINE GENERATOR



650
950
1000
1100

OPERATION MANUAL

Notes

1. SAFETY INFORMATION

EXHAUST FUMES IS POISONOUS.

Never operate generator indoors.



FUEL IS HIGHLY FLAMMABLE.

Stop generator when refuelling.



No Smoking while refuelling.



Take care not to spill fuel.

Never place near inflammables.



Never operate in wet weather conditions.

Never touch with wet hands.



Ground (earth) the generator.

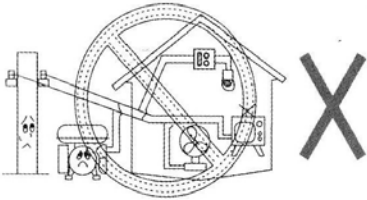
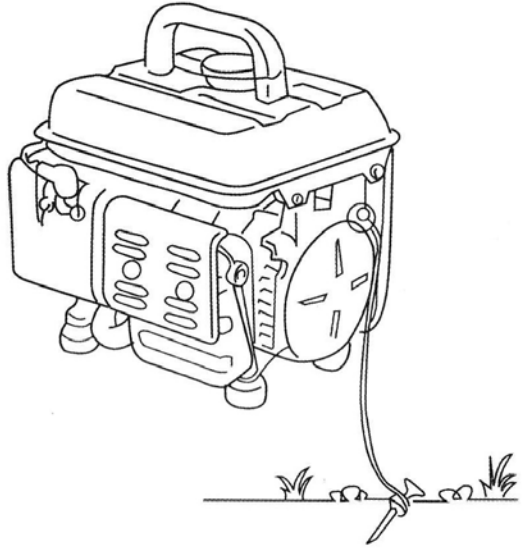

DO NOT connect to commercial power outlet.

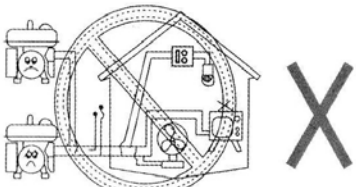

DO NOT connect to another generator.

2. PRE-OPERATION CHECK

Fuel tank capacity is 4L.

Use petrol mixed with 2 stroke engine oil.

Do not make fuel reach the top of fuel filter.

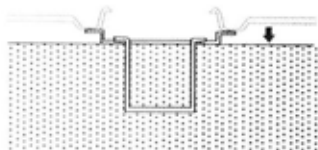

How to make the mixture of petrol and 2 stroke engine oil:

Petrol and 2 stroke engine oil mixing ratio is 50:1.

50 parts petrol : 1 part 2 stroke engine oil.

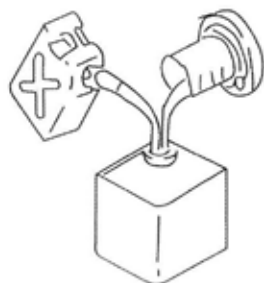

Use fuel tank cap to measure as:

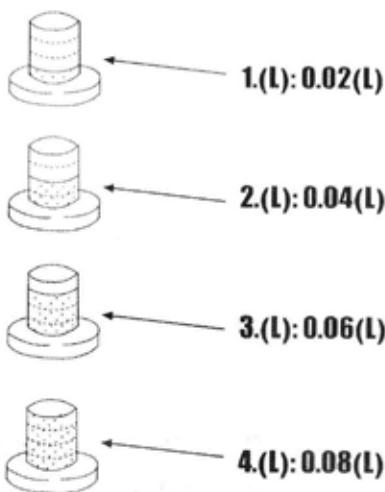

Shake fuel tank after fueling.

3. STARTING THE ENGINE

Before starting, DO NOT connect with any electrical appliances.

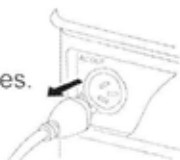

1. Turn fuel cock to "ON" position.



2. Turn choke lever to "CLOSE".

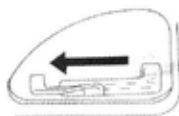

3. Turn engine switch to "ON".



4. Pull slowly on recoil starter until engaged,
then pull it briskly.



5. Turn choke lever to "OPEN".

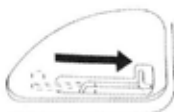

4. STOPPING THE ENGINE

Before stopping, turn off all electrical appliances.

1. Turn engine switch to "STOP".
2. Turn fuel cock to "OFF" position.

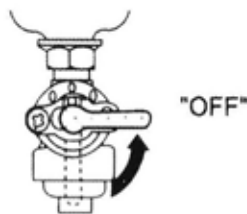
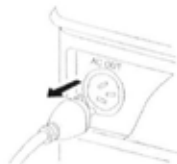

5. CONNECTION

1. Wind lead 2 or 3 turns around the handle.
2. Start generator.
3. Plug into AC socket.

Battery charger (if equipped):

Connect red lead (provided as accessory) to positive (+) pole and black to negative (-) pole.

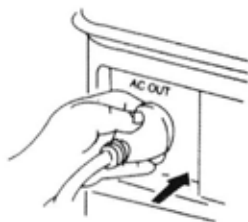



SAFETY DEVICES

Press to reset AC or DC protector.

Reduce load under the Max limit of rated output, if AC or DC protector (if equipped) trips.

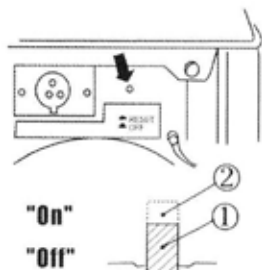
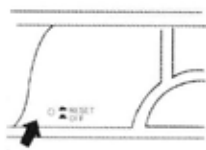

6. PERIODIC MAINTENANCE

ITEM	REMARKS	Every 50hrs Or Every month	Every 150hrs Or Every 3 months
Spark plug	Remove carbon, Adjust gap. Replace if necessary.	•	
Air filter	CLEAN. Replace if necessary.		•
Fuel filter	CLEAN. Replace if necessary.		•

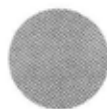

SPARK PLUG

1. Remove spark plug.
2. Remove carbon deposits.
3. Check spark plug for discolouration.
Standard colour is Tan.
4. Check spark plug gap 0.7-0.8mm (0.028-0.031").

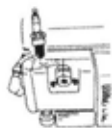

AIR FILTER

1. Remove air filter.
2. Wash in solvent.
3. Pour engine oil (if generator is operated in a dusty area).
4. Squeeze out any extra engine oil.
5. Replace air filter.

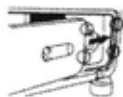
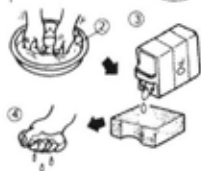
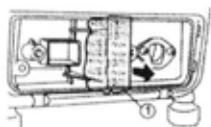

Never run generator without the air filter element.



FUEL FILTER

1. Stop generator.
2. Unscrew fuel cap and take out fuel filter cup.
3. Clean in solvent.
4. Wipe off and insert back.

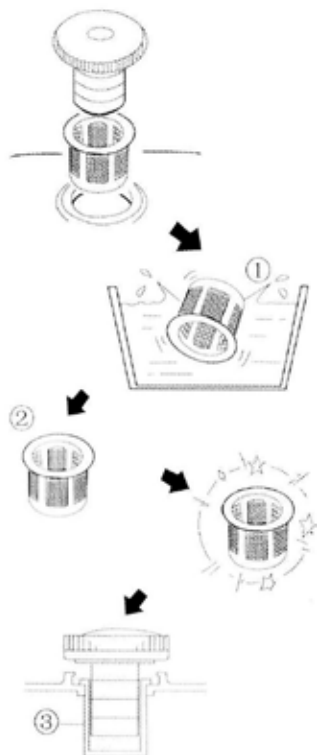

7. APPLICATION RANGE

Apparatus		650	950	1000	1100	Power factor	
AC		50 Hz	~450 W	~ 650 w	~ 720w	~ 850w	1
		60 Hz	~550 W	~ 800 w	~ 850 w	~ 950 w	
		50 Hz	~330 W	~ 480 w	~ 540 w	~ 640 w	0.7-0.8
		60 Hz	~410 W	~ 600 w	~ 640 w	~ 710 w	
		50 Hz	~390 W	~ 570 w	~ 620 w	~ 730 w	0.7-0.95
		60 Hz	~480 W	~ 700 w	~ 730 w	~ 820 w	

If DC output is equipped

DC		12V/8.3A	Max chargeable battery capacity:40 A.h
----	---	----------	--

8. TROUBLE SHOOTING



ENGINE WILL NOT START.

1. Check fuel.
2. Check fuel cock is turned "ON".
3. Check generator switch is turned "ON".
4. Check spark plug.

If generator still will not start, check the following:

1. Fuel cock clogging.
2. Air filter clogging.

Or consult your dealer.

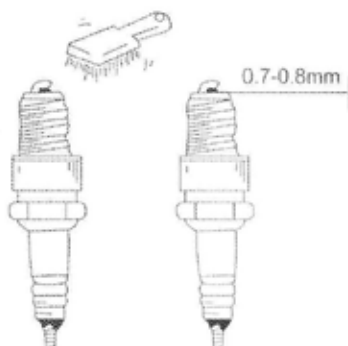

SPECIFICATIONS

		Model		650		950		1000		1100			
ALTERNATOR	Type	Single-phase, brushless, self-excitation alternator											
	Frequency	Hz	50	60	50	60	50	60	50	60	50	60	
	Voltage	V	110, 115, 120, 220, 230, 240 Optional										
	Rated output	W	450	550	650	800	720	850	850	950			
	Max. output	W	500	600	720	880	800	1000	900	1100			
	Volt regulator	Capacitor											
ENGINE	Type	Single-cylinder, air-cooled, reed-Valve, 2-stroke gasoline engine											
	Displacement	cc.	63						74				
	Starting system	Recoil starter											
	Recommended fuel	Unleaded gasoline											
	Lube oil	2-stroke engine oil, pre-mixed with fuel 50:1											
UNIT	Fuel tank capacity	L	4.0										
	Running time	hr	8	6	6	4.5	4.5	3					
	Noise level	dB(A)	57(At 7m)										
	Dimensions(LxWxH)	mm	400x330x330										
	Dry weight	kg	16.5		18.5					20.5			